

BARUM CZECH RALLY ZLÍN

powered by Continental



**AUTOKLUB
ČESKÉ REPUBLIKY**

15. – 17. 8. 2025



Supplementary Regulations

Zlínský kraj
Kraj bez hranic



zlín.

#VisitCzechia

Česko žije
sportem



NÁRODNÍ
SPORTOVNÍ
AGENTURA

SHERON

Barum

Vytrvalost, odvaha a touha překonávat hranice

– to je Zlínský kraj!



**Jsme hrdým partnerem Barum Czech Rally Zlín,
protože víme, že úspěch je o překonávání limitů.
A my se hranic nebojíme!**

#jsmezlinskykraj

#krajbezhranic

Zlínský kraj bez hranic

Zlínský kraj



Zlínský kraj – oficiální stránka



@zlinskykraj



@zlinsky_kraj_official



www.zlinskykraj.cz



Past overall winners

1971	J. Halmazňa	-	V. Kostruh	CSR	Škoda 1100 MB
1972	V. Hubáček	-	V. Rieger	CSR	Renault Alpine A110
1973	V. Hubáček	-	S. Minařík	CSR	Renault Alpine A110
1974	W. Hauck	-	W. P. Pitz	DEU	Porsche 911 Carrera
1975	V. Hubáček	-	S. Minařík	CSR	Renault Alpine A110
1976	J. Haugland	-	A. Antosen	NOR	Škoda 130 RS
1977	V. Blahna	-	L. Hlávka	CSR	Škoda 130 RS
1978	J. Šedivý	-	J. Janeček	CSR	Škoda 130 RS
1979	J. Haugland	-	J. O. Bohlin	NOR / SWE	Škoda 130 RS
1980	J. Haugland	-	J. O. Bohlin	NOR / SWE	Škoda 130 RS
1981	A. Zanussi	-	S. Fachim	ITA	Porsche 911 SC
1982	G. Kalnay	-	F. Hinterleitner	AUT	Opel Ascona 400
1983	L. Křeček	-	B. Motl	CSR	Škoda 130 RS
1984	H. Demuth	-	W. Lux	DEU / BEL	Audi 80 Quattro
1985	H. Demuth	-	E. Radaelli	DEU / ITA	Audi Quattro A2
1986	L. Pavlík	-	K. Jirátko	CSR	Audi Quattro A2
1987	A. Ferjancz	-	J. Tandari	HUN	Audi Coupe Quattro
1988	F. Wittmann	-	J. Pattermann	AUT	Lancia Delta HF 4WD
1989	F. Wittmann	-	J. Pattermann	AUT	Lancia Delta HF Integrale
1990	M. Sundstroem	-	J. Repo	FIN	Mazda 323 4WD
1991	P. Snijers	-	D. Colebunders	BEL	Ford Sierra RS Cosworth
1992	E. Weber	-	M. Hiemer	DEU	Mitsubishi Galant VR-4
1993	R. Baumschlager	-	K. Wicha	AUT / DEU	Ford Escort RS Cosworth
1994	P. Snijers	-	D. Colebunders	BEL	Ford Escort RS Cosworth
1995	E. Bertone	-	M. Chiapponi	CZE	Toyota Celica Turbo 4WD
1996	S. Chovanec	-	H. Kurus	SVK	Ford Escort RS Cosworth
1997	E. Bertone	-	M. Koči	CZE / SVK	Toyota Celica GT-Four
1998	E. Bertone	-	M. Koči	CZE / SVK	Toyota Celica GT-Four
1999	J. Kulig	-	E. Horniaček	POL / SVK	Toyota Celica GT-Four
2000	R. Kresta	-	J. Tománek	CZE	Škoda Octavia WRC
2001	R. Kresta	-	J. Tománek	CZE	Škoda Octavia WRC
2002	R. Travaglia	-	F. Zanella	ITA	Peugeot 206 WRC
2003	V. Pech	-	P. Uhel	CZE	Ford Focus RS WRC
2004	S. Jean-Joseph	-	J. Boyere	FRA	Renault Clio S1600
2005	R. Travaglia	-	F. Zanella	ITA	Renault Clio S1600
2006	R. Kresta	-	P. Gross	CZE	Mitsubishi Lancer EVO IX
2007	N. Vouilloz	-	N. Klinger	FRA	Peugeot 207 S2000
2008	F. Loix	-	R. Buysmans	BEL	Peugeot 207 S2000
2009	J. Kopecký	-	P. Starý	CZE	Škoda Fabia S2000
2010	F. Loix	-	F. Miclotte	BEL	Škoda Fabia S2000
2011	J. Kopecký	-	P. Starý	CZE	Škoda Fabia S2000
2012	J. Hänninen	-	H. Markkula	FIN	Škoda Fabia S2000
2013	J. Kopecký	-	P. Dresler	CZE	Škoda Fabia S2000
2014	V. Pech	-	P. Uhel	CZE	Mini John Cooper Works S2000
2015	J. Kopecký	-	P. Dresler	CZE	Škoda Fabia R5
2016	J. Kopecký	-	P. Dresler	CZE	Škoda Fabia R5
2017	J. Kopecký	-	P. Dresler	CZE	Škoda Fabia R5
2018	J. Kopecký	-	P. Dresler	CZE	Škoda Fabia R5
2019	J. Kopecký	-	P. Dresler	CZE	Škoda Fabia R5 Evo
2021	J. Kopecký	-	J. Hloušek	CZE	Škoda Fabia Rally2 Evo
2022	J. Kopecký	-	J. Hloušek	CZE	Škoda Fabia Rally2 Evo
2023	J. Kopecký	-	J. Hloušek	CZE	Škoda Fabia RS Rally2
2024	D. Střiteský	-	J. Hovorka	CZE	Škoda Fabia RS Rally2

SUPPLEMENTARY REGULATIONS

54th BARUM CZECH RALLY ZLÍN 2025

15.-17.8.2025

FIA European Rally Championship for Drivers and Co-Drivers
FIA European Rally Championship for Teams
FIA European Rally Championship for Tyre Suppliers
FIA ERC 3 Championship for Drivers and Co-Drivers
FIA ERC 4 Championship for Drivers and Co-Drivers
FIA Junior ERC Championship for Drivers
FIA Master ERC Championship for Drivers
M-Sport Fiesta Rally3 Trophy

TABLE OF CONTENTS

1.	Introduction
2.	Organisation
3.	Programme
4.	Entries
5.	Insurance
6.	Advertising and Identification
7.	Tyres
8.	Fuel, Refuelling
9.	Reconnaissance
10.	Administrative Checks
11.	Scrutineering, Marking and Sealing
12.	Other procedures
13.	Identification of Officials
14.	Prizes
15.	Final Checks
Appendix 1	Itinerary
Appendix 2	Reconnaissance schedule
Appendix 3	CROs – names, photographs and duties schedule
Appendix 4	Competition numbers and advertising
Appendix 5	Drivers equipment, Appendix L
Appendix 6	GPS tracking system
Appendix 7	Accommodation

1. INTRODUCTION

1.1 General

This rally will be run in compliance with the FIA International Sporting Code including appendices, the FIA Regional Rally Sporting Regulations including appendices, the WADA/NADA Codes and the FIA Anti-Doping Regulations, as amended from time to time. The National Road Traffic Regulations shall apply. Unless provided otherwise by these Supplementary Regulations, the provisions of the above Rules and Regulations shall apply.

Modifications, amendments and/or changes to these Supplementary Regulations will be announced only by numbered and dated Bulletins (issued by the organiser or the Stewards).

Additional information will be published in the Rally Guide 2, issued on 4. 8. 2025. The FIA Regional Rally Championships Sporting Regulations can be found at <https://www.fia.com/regulation/category/117>

1.2 Surface

95,5 % tarmac of various quality and 4,5 % gravel/mineral surface

1.3 Overall SS distance and total distance of the itinerary

- Total distance of the SS: 207,49 km
- Total distance of the rally: 754,15 km

1.4 Official Name of the event

The official name of the rally is "Barum Czech Rally Zlín"

2. ORGANISATION

2.1 Championships and titles for which the rally counts

2.1.1 FIA Championships

FIA European Rally Championship for Drivers and Co-Drivers
FIA European Rally Championship for Teams
FIA European Rally Championship for Tyre Suppliers
FIA ERC 3 Championship for Drivers and Co-Drivers
FIA ERC 4 Championship for Drivers and Co-Drivers
FIA Junior ERC Championship for Drivers
FIA Master ERC Championship for Drivers

2.1.2 Other titles for which the rally counts:

M-Sport Fiesta Rally3 Trophy

2.1.3 ASN titles for which the rally counts:

Autoklub Czech Rally Championship
Autoklub Rally Challenge
Czech Junior Championship
Czech Ladies' Trophy
Cup 55+
Toyota Yaris Cup Czech

2.2 VISA numbers

FIA visa No.: **011AR250516**
ASN visa No.: **06ERC/250617**

2.3 Organiser's name, address and contact details

Auto Klub Barum Zlín in ACR (AK Barum)
Hornomlýnská 3715, 760 01 Zlín (49.2290339N, 17.6746392E)
Czech Republic
Tel.: +420 577 210 677, +420 577 432 004, +420 577 437 024
E-mail: info@czechrally.com
Web: www.czechrally.com

Co-organiser

Rallye Zlín spol.s r.o.,
Hornomlýnská 3715, 760 01 Zlín
Czech Republic

2.4 Organising Committee:

Chairman: Mr. Miloslav Regner
Members: Mr. Jan Regner, Mr. Martin Konečný, Mrs. Marta Regnerová, Mrs. Věra Šmakalová.

2.5 Stewards of the Meeting:

Chairperson	Jordi Parro	ESP
FIA Steward	Joe Corcoran	IRL
ASN Steward	Tomáš Kunc	CZE

2.6 FIA Delegates

FIA Sporting Delegate	Miikka Anttila
FIA Safety Delegate	Benjamin Schmidt
FIA Technical Delegate	Emanuele Saglia
FIA Technical Delegate Assistant	Mohand Abdelmoula

2.7 Senior officials

Clerk of the Course	Jan Regner
Deputy CoC	Miloslav Regner
	Martin Konečný
	Petr Linhart
	Jakub Hofbauer
Secretary of the Rally	Květoslav Malota
Chief of Route	Vojtěch Valenta
Chief of Special stages	Zdenek Gavenda
ASN Safety Delegate	Michal Mikeš
Chief Scrutineer	Lukáš Kusý
Chief Timekeeper	Hana Hlobilová
Competitors' Relations Officers	Wolfgang Gastorfer
	Veronika Havelková
Secretary of the Stewards of the Meeting	Kristýna Panušková
Environmental Officer	Žaneta Pěrková
Chief Safety Officer	Květoslav Malota
Press Relations Officer	Roman Ordelt
GPS system	SAS (Status Awareness Systems)
Chief Medical Officer	MUDr. Lubomír Nečas
Assistant of the Chief Medical Officer	MUDr. Tomáš Novotný
Results processing	SAS (Status Awareness Systems)

2.8 HQ Location

Place: **Rally HQ - Permanent Secretariat (AK Barum)**, Hornomlýnská 3715, 76001 Zlín
(GPS: 49°13'44.63"S, 17°40'28.92"E)

Date: 12. 8.2025 Time: 08:00-20:00
13. 8.2025 08:00-21:00
18. 8.2025 10:00-12:00

Place: **Rally HQ - Regional Authority**— Building 21, třída T. Bati 21, 761 90 Zlín
(GPS: 49°13'23.29"S, 17°39'30.77"E)

Date: 14. 8.2025 Time: 08:00-23:00
15. 8.2025 07:00-24:00
16. 8.2025 07:00-23:00
17. 8. 2025 06:30-21:00
Tel.: +420 577 210 677, +420 577 432 004, +420 577 437 024
E-mail: info@czechrally.com

2.9 Location of Parc Fermé

Place: Zlín, next to Rally HQ 15.-17.8.2025
(GPS: 49°13'21.91"S, 17°39'44.19"E)

2.10 Location of the Press Centre

Place: Foyer AB Continental Barum, Otrokovice (GPS: 49°11'59.17"S, 17°31'39.73"E)

Date: 14 August 2025 Time: 14:00-23:00
15 August 2025 07:00-24:00
16 August 2025 08:00-23:00
17 August 2025 08:00-20:00

2.11 Official Notice Board location

Digital Notice Board (DNB) on www.czechrally.com

As provided for in FIA ISC Art. 11.9.4 the Official Notice Board will be the Digital Official Notice Board (DNB) published on the event website: www.czechrally.com

There will be no physical official notice board. Additionally, rally documents will also be available in the **Sportity app** (downloadable for iOS devices on Appstore and for Android devices on Google Play):
Password is **Barum2025**

During the event, individual and general communication between all Rally Officials (Rally Control/COC, Rally Secretariat, CRO, Stewards, Technical Staff etc.) and the competitors/crew members will primarily and as far as possible be conducted via Sportity App.

For this purpose, each competitor is required to nominate ONE official representative authorized for the purpose of receiving any official notifications. As some of these notifications can be issued while rally cars are on stages, this person can neither be the driver nor the co-driver. This person should be a team representative who is based in the Service Park during the event.

This contact (name, title, cell phone, email) must be nominated at the latest on 28. 7. 2025 and sent by email to entry@czechrally.com, and will be used both for general and individual communications.

3. PROGRAMME

Tuesday, 16.6.

Publication of the Supplementary regulations www.czechrally.com, DNB
Opening date for Entries

Monday, 28.7.

24:00 Closing date for Entries
24:00 Closing date for additional space and other requests for the service area

Monday, 4.8.

18:00 Publication of the List of Entries approved by the FIA www.czechrally.com, DNB
21:00 Issuing of the road book, maps, Rally Guide 2, KMZ-file and stage videos (all in electronic form) www.czechrally.com

Wednesday, 6.8.

12:00 Closing date for Onboard camera application Digital form

Friday, 8.8.

18:00 Closing date for helicopter registration AK Barum

Wednesday, 13.8.

08:00 - 17:00	Reserved area for teams after official test	Luhačovice
08:00 - 13:00	Distribution of the road book and GPS units for the reconnaissance (all drivers) – see article 11.7.5.	AK Barum
08:00 - 13:00	Distribution of onboard camera stickers (ERC starting field)	AK Barum
08:00 - 13:00	Distribution of GPS for the rally (all drivers)	AK Barum
08:00 - 13:00	Optional administrative check	AK Barum
12:00 - 18:00	Reconnaissance	See Art. 9 and Appendix 2 SR
17:00 - 21:00	Possible entry to a part of service area (testing track Continental Barum) – only for parking of service cars and trucks on their places (for free for official pre-event test participants only)	See Art. 12.5 SR
19:30 - 20:30	Autograph session (on invitation only)	Shopping centre Zlaté Jablko
20:00	Closing date for drivers' safety tracking e-learning course *	Online

Thursday, 14.8.

08:00 - 23:00	Rally HQ opening times	Building 21, Zlín
08:00 - 19:00	Reconnaissance	See Art. 9 and Appendix 2 SR
08:00	Opening of service area (only for cars with correct stickers)	See Art. 12.5 SR
12:30 - 21:30	Administrative check	Rally HQ (Building 21)
13:30 - 22:30	Scrutineering of the cars, marking and sealing	Otrokovice
14:00	Opening of press centre and media accreditation	AB Continental Barum
18:00	Media safety briefing (obligatory **)	AB Continental Barum
19:00 - 20.15	Promoter photoshoot for all first time 2025 ERC competitors	Vestibule AB Continental Barum
19:30	Team managers meeting (ERC registered only)	Vestibule AB Continental Barum
23:15 - 01:00	Reconnaissance SSS Zlín	See Art. 9 and Appendix 2 SR
23:30 - 01:15	Returning reconnaissance GPS units in Stop of SSS 1 Zlín	Zlín, Zarámí street

Friday, 15.8.

06:30 - 07:30	Re-scrutineering	Otrokovice, Service park out
07:00 - 24:00	Rally HQ opening times	Building 21, Zlín
08:00 - 09:20	Free practice (FIA & ERC1 priority drivers with Rally2 cars)	Komárov
09:00	Publication of the Amended Entry List	DNB
	Publication of the Starting list for the qualifying stage	DNB
	Publication of Starting lists for ceremonial start, start of Leg 1, section 1	DNB
09:31 - 10:10	Qualifying stage (FIA & ERC1 priority drivers with Rally2 cars)	Komárov
10:15- 13:00	Shakedown	Komárov
11:00	Publication of Provisional classification QS	DNB
12:00	Publication of Starting list for Leg 1, section 2	DNB
15:30	Meet the Crews	Zlín, square in front of town hall
16:00	Ceremonial start of the rally	Zlín, square in front of town hall
18:00	Briefing with helicopter pilots or their deputies	ERC Office, Barum Otrokovice
22:15	Start of Leg 1 section 1 (FIA ERC), See Art. 12.1.1. SR	Vodní street
22:50	Finish of Leg 1 section 1, TC 1A (FIA ERC)	Next to Rally HQ

Saturday, 16.8.

07:00 - 23:00	Rally HQ opening times	Building 21, Zlín
07:30	Start of Leg 1 section 2 (TC 1B)	Next to Rally HQ
20:13	Finish of Leg 1	Next to Rally HQ
21:00	Publication of Starting list for Leg 2	DNB

Sunday, 17.8.

06:30 - 21:00	Rally HQ opening times	Building 21, Zlín
06:30	Start of Leg 2	Next to Rally HQ
(17:30)	Prize Giving and Press conference	Zlín, square in front of town hall
	Finish of the rally (last TC)	Next to Rally HQ
18:30	Final Scrutineering	Samohýl Motor Zlín, a.s.
20:30	Posting of the provisional classification	DNB
21:30	Deadline for returning GPS unit	SAS tent at parc ferme

* Obligatory for all ERC drivers and co-drivers to pass the e-learning online course until date mentioned in programme (link will be send separately by email), the only exception being if they have already e-learning certificate from any previous ERC or WRC round this year. Without attending this e-learning course crew cannot pass administrative checking

** Obligatory for all media accreditation applicants (FIA ERC permanent included)

4. ENTRIES

4.1 Closing date for entries

Closing date for entries: 28. 7.2025 at 24:00

4.2 Entry procedure

Each competitor of FIA ERC (ERC registered) must complete the ONLINE version of Entry form of the rally on the website: <https://registrations.fia.com/rally>

Each nonregistered competitor of FIA ERC must complete the ONLINE version of Entry form of the rally on the website: <https://registrations.fia.com/ercenze>

All competitors (FIA ERC registered, FIA ERC non registered and Czech Rally Championship) of Barum Czech Rally Zlín must complete also the Czech version of entry form available on the website: <https://www.czechrally.com> in section competitors, they shall also fill the form with the details concerning the Service Park (additional space and other requests for the service area as the electricity, team members, etc.). E-mail for communication regarding entries and service requests is entry@czechrally.com

All competitors taking part in a Championship event must ensure that their drivers and co-drivers sign the Driver's Declarations and Undertakings form as attached in RRSR Appendix XIV.

This form is available at <https://www.fia.com/regulation/category/117> (RELATED DOCUMENTS section).

Please print, fill in and sign the Driver's Declaration.

The completed and signed Driver's Declaration must be handed to the organiser at the administrative checks.

All competitors wishing to use an on-board camera must apply via the ERC Accreditation Portal at least one week before the start of reconnaissance.

Those registering for an OBC for the first time in the 2025 ERC Season should first use this link:

<https://qrco.de/ERCBCSeasonRegistration>.

Those who have already applied for an OBC in 2025 should use their e-mail address to register via this link (no password required) <https://qrco.de/ERCBCForm>.

4.3 Number of accepted entrants and classes

4.3.1 The number of entrants is limited by 150 cars.

4.3.2 For participation of rally cars the article 12 of the 2025 FIA RRSR will be followed.

Permitted groups and classes		
Classes	Groups	
RC2	Group Rally2	Group Rally2 cars conforming to the 2025 Appendix J, Art 261
	Group Rally2 Kit (VR4K)	Cars fitted with R4 Kit conforming to the 2025 Appendix J, Art. 260E
	Group NR4 over 2000cc	Group N cars conforming to the 2019 Appendix J, Art 254
	S2000-Rally 2.0 Atmospheric	Super 2000 cars (conforming to the 2013 Appendix J, Art 254A)
RGT	Group RGT cars	Group RGT cars conforming to the 2019 Appendix J, Art 256 Group RGT cars conforming to the 2025 Appendix J, Art 256
RC3	Rally3 (atmo over 1390cc and up to 2000 cc and turbo over 927cc and up to 1620cc)	Group Rally3 cars homologated from 01/01/2021 and conforming to the 2025 Appendix J, Art. 260
RC4	Rally4 (atmo over 1390cc and up to 2000cc and turbo over 927cc and up to 1333cc)	Group Rally4 cars homologated from 01/01/2019 and conforming to the 2025 Appendix J, Art. 260 Group R2 cars homologated before 31/12/2018 and conforming to the 2018 Appendix J, Art. 260
	R3 (atmo / over 1600cc and up to 2000cc and turbo over 1067cc and up to 1333cc)	Group R cars homologated before 31/12/2019 and conforming to the 2019 Appendix J, Art. 260
	R3 (turbo / up to 1620cc / nominal)	Group R cars homologated before 31/12/2019 and conforming to the 2019 Appendix J, Art. 260D
	Group A up to 2000cc	Group A cars conforming to the 2019 Appendix J, Art. 255
RC5	Rally5 (atmo up to 1600cc and turbo up to 1333cc)	Group Rally5 cars homologated from 01/01/2019 and conforming to the 2025 Appendix J, Art. 260
	Rally5-Kit (atmo or turbo up to 1600cc)	Group Rally5-Kit cars homologated from 01/01/2025 and conforming to the 2025 Appendix J, Art. 260B
	Rally5 (atmo up to 1600cc and turbo up to 1067cc)	Group R1 cars homologated before 31/12/2018 and conforming to the 2018 Appendix J, Art. 260

4.4 Entry fees including insurance (see art. 5.2.):

With the optional advertising proposed by organisers	Entry fee
ERC1 priority driver, non-registered in class RC2	3 300 €
ERC3 priority driver, RGT, non-registered in class RC3	2 400 €
ERC4 priority driver, non-registered in classes RC4, RC5	1 900 €
M-Sport Fiesta Rally3 Trophy	1 500 €
ERC Junior driver	1 500 €
Without the optional advertising proposed by organisers	Entry fee
ERC1 priority driver, non-registered in class RC2	6 600 €
ERC3 priority driver, RGT, non-registered in class RC3	4 800 €
ERC4 priority driver, non-registered in classes RC4, RC5	3 800 €
M-Sport Fiesta Rally3 Trophy	3 000 €
ERC Junior driver	3000 €

Entry packages for registered drivers in ERC

Printed materials	ERC 1	ERC 3/ RGT	ERC 4
Supplementary regulations	2	1	1
Road Book	2	1	1
Official programme of the rally	2	2	2
Reconnaissance book	1	1	1
Service road book	Will not be printed – available only at www.czechrally.com		
Rally Guide	Will not be printed – available only at www.czechrally.com		

Stickers	amount	amount	amount
Rally car	1	1	1
Service car	2	2	2
Car for reconnaissance	1	1	1
Auxiliary	1	1	1
Guest	1	0	0

Passes	amount	amount	amount
Drivers	2	2	2
Service	8	6	6

Entry packages for non-registered drivers in ERC

Printed materials	Priority FIA & ASN	RC 2	RC3, RGT
Supplementary regulations	1	1	1
Road Book	1	1	1
Official programme of the rally	2	2	2
Service book	Will not be printed – available only at www.czechrally.com		
Reconnaissance book	1	1	1

Stickers	amount	amount	amount
Rally car	1	1	1
Service car	2	2	2
Car for reconnaissance	1	1	1
Auxiliary	1	1	1

Tickets	amount	amount	amount
Drivers	2	2	2
Service	6	4	4

4.5 Payment details

By post-office money order or by bank transfer to:

Bank: KB Zlín, Tr. Tomáše Bati 152, 760 01 Zlín
Account holder: Rallye Zlín, spol. s r.o.
Account No.: 107-3439240207/0100 IBAN: CZ22 0100 0001 0734 39240207
Variable symbol.: generated in is.autoklub.cz Swift: KOMBCZPPXXX

Acceptance of Entry form

An entry application will be accepted only if both entry forms will be filled and accompanied by the total entry fees or by a receipt issued by the competitor's ASN. The organizer has the right to refuse entry of a driver except FIA and ERC registered drivers.

4.6 Refunds

Entry fees will be fully refunded:

- to candidates whose entry has not been accepted
- in the case of the rally not taking place.
- In the case of force majeure for the competitor, after investigation by the Stewards.

The organisers may partially refund the entry fee to those entrants who, for reasons of „force majeure” (duly certified by their ASN), were unable to start in the rally and excused themselves before the start of the administrative checks. The crews who do not excuse themselves will be announced to ASN and the entry fee will not be reimbursed.

5. INSURANCE

5.1 Insurance Coverage for the Organizer

5.1.1 The Autoklub of the Czech Republic (ACCR) has made the insurance contract with Allianz pojišťovna, a. s. through the PLATINUM Consulting, s. r. o. company, a framework agreement no. C550012623, organizer's liability insurance covering damage caused to the third party during the competition up to 2 000 000 EUR per incident.

5.1.2 The part of the insurance agreement is the coverage for cars against the damage caused to third party up to 2 000 000 EUR per participant. However, the damage caused by drivers among themselves is not covered by this contract.

The organizer binds self to arrange this insurance contract for all competitors except those, who will show the long-term liability insurance covering damages caused on closed route.

5.1.3 The insurance for organizers and participants is made with an integral excess of 5 000 CZK. It means that damage up to 5 000 CZK won't be refunded and damage over 5 000 CZK will be covered without the complicity of insured.

5.1.4 All crews at administrative check have to hand in the valid International Green Card for their car. Without this card the crew won't be permitted to start.

5.2 Insurance Coverage for the competitors and crews

All the drivers and co-drivers are obliged to arrange their own accident insurance. The proof should be documented on request at administrative check. The insurance of foreign crews has to cover the costs of possible medical treatment in the Czech Republic. Insurance cover must start from Free Practice / Shakedown until Parc Fermé after the finish of the rally.

5.3 Damage Reporting

The crews are obliged to notify the organizer about the damage caused on the track by their car by the end of event the latest. Violation of this duty stands for summoning the competitor and involved crew to a disciplinary committee.

5.4 Insurance Coverage Exclusions

Auxiliary vehicles, cars dedicated to reconnaissance rides and vehicles with special labels issued by the organiser are not covered by the provided rally insurance (with the exception of insured organiser's cars) and those are always going on their own responsibility.

6. ADVERTISING AND IDENTIFICATION

6.1 Compulsory advertising

- A - starting numbers: Barum
B - rally plates: Barum
C - rear window panel: Barum

6.2 Optional advertising proposed by organiser

The organiser reserves following places which must remain free:

- D - panel 67 x 20 cm under the side door starting number: Zlín, ORLEN, ACCR, Zlínský kraj, VisitCzechia
E - panel 67 x 20 cm under the side door starting number: Zlín, ORLEN, ACCR, Zlínský kraj, VisitCzechia
ERC - ERC advertising stickers (front windscreen, rear windscreen, door strip)

Placement of advertisings proposed by organiser is given in Appendix 4 of these supplementary regulations.

6.3 Loss or removal of advertising

If there is ascertained at any point during the rally that an advertising sticker (or any other type of advertisement) supplied by the organiser is missing from a car then the crew shall be reported to the Stewards.

6.4 Competition numbers and rally plates

Competition numbers and rally plates according to the Article 28 of FIA RRSR supplied by the organiser must appear on both front doors of the car during the whole rally. If it is ascertained at any time during the rally that:

- a competition number or one rally plate is missing, will be reported to the Stewards
- both competition numbers on front doors or both rally plates are missing; this will be reported to the Stewards.

7. TYRES

7.1 Tyres specified for use during the rally

At all times during the event in the Czech Republic, the tread depth of the tyres fitted on the car, must not be less than 1.6 mm. All tyres used during the rally must be in conformity with RRSR Art. 13 and with Appendix V.

7.1.1 Tyres for all ERC-priority competitors

Tyres must be supplied by an FIA-nominated tyre manufacturer and must be included in list of barcodes and matching tyre types (including compound) which will be provide to the FIA Technical Delegate before the end of each pre-rally scrutineering. A list of FIA-nominated tyre manufactures is published on FIA.com.

7.1.2 Tyre Quantities

Cars	Max. Number of tyres
RC2, RC3 and RGT	16
RC4 and RC5	12

For competitors eligible to take part in Qualifying, tyres will be taken from the overall quantity as per Art. V1a 15.1, except the spare wheel(s) fitted in the car.

For Free Practice and Shakedown tyres will not count from the overall quantity.

7.2. Eligible tyres for the ERC Junior Championships

7.2.1 Tyres for Junior ERC Championship

For the Junior ERC Championship only Hankook tyres, sold at the rallies by the Junior ERC Championship tyre supplier, are eligible.

Competitors registered for the Junior Erc Championship must use the following type of tyres:

TYRE MANUFACTURER	TYRE SIZE	NAME	USAGE
HANKOOK	190/600R16 or 190/630R17	T53	Hard
	190/600R16 or 190/630R17	T72	Soft
	180/600R16 or 180/625R17	W53	Wet

7.2.2 Quantities of tyres for Junior

The maximum quantity for Junior ERC drivers for whole event is 12 to be chosen from the list below:

TYRE SIZE	NAME	QUANTITY
190/600R16 or 190/630R17	T53	12
190/600R16 or 190/630R17	T72	6
180/600R16 or 180/625R17	W53	6

7.3 Tyre marking

7.3.1 Tyre marking for the tyres that will be used during the Qualifying will be placed between the TCQS and START QS.

7.3.2 Tyre marking for the tyres will be organised before SSS 1 Zlín and at Service Parks OUT (after TC1D, 4C, 7G and 10C), as shown in the Road Book.

7.4 Tyres for use on reconnaissance

Only road-homologated series production tyres for asphalt are allowed.

8. FUEL, REFUELLING

8.1 Fuel

Fuel must be in compliance with FIA 2025 Appendix J, 252.9.

8.2 Refuelling

Crews may refuel only in the designated refuelling areas mentioned in the road book, see below:

- Exit of Service area Otrokovice on 15.8. from 7:00 to 15:30
- Exit of Service area Otrokovice on 16.-17.8. according to road book and itinerary of the rally
- Remote Refuel Zlín (16.8.) and Slušovice (17.8.) according to road book and itinerary of the rally

8.2.1 FIA Junior ERC Refuelling

FIA Junior ERC competitors are allowed to use ONLY fuel 100 octane from the **ORLEN**, Petrol station, Vizovická 375, Příluky, 760 01 Zlín (GPS: N 49°13,246', E 17°42,475') designated in the road book.

Service crews are allowed to fill this fuel in their canisters, and refuel Junior ERC cars in designated Refuel areas and Remote Refuelling areas.

8.3 Refuelling procedure

In order to access the Refuelling area, all personnel involved in refuelling operations must wear clothing that provides adequate protection against fire and includes at least: long trousers, long-sleeved top, closed shoes, gloves and a balaclava. It is required that the crew remain outside the car during refuelling.

9. RECONNAISSANCE

9.1 Reconnaissance registration

Before the beginning of reconnaissance each crew announces a factory make and a registration plate number of its reconnaissance car and present the driving licence. The crew receives identification for its car (starting number) and monitoring GPS unit. GPS unit must be in a Recce car during whole time while making Reconnaissance, also in liaisons. Starting number must be affixed in right upper part of the windscreen during reconnaissance at all the times. Any change of the car must be announced to the organiser in time. **GPS unit must be returned to the organiser in the end of Reconnaissance of SSS 1 Zlín – Stop control.** Time of each Crew for the reconnaissance of SSS 1 will be published on notice board and will be over given when collecting the road books for Recce. Crew can enter the area before SSS Zlín earliest 20 minutes before their scheduled time. Earlier arrival to the start of SSS 1 recce will be penalised by CoC by 200 Eur.

9.2 Reconnaissance schedule is available in Appendix 2 SR.

9.3 Reconnaissance rules

The crews are obliged to follow general traffic regulations that will be controlled. Speed limit is 90km/h unless lower speed is indicated by traffic signs.

9.3.1 Reconnaissance will be organised in compliance with art. 35 of the FIA RRSR and only series production cars conforming to art. 35.1 of FIA RRSR can be used.

9.3.2. As from the publication of the rally Supplementary Regulations, any driver, or his co-driver, or any other team member who has entered or intends to enter Barum Czech Rally Zlín and who wishes to drive on any road which is used as a special stage in that rally, may only do so after he has obtained the organiser's written permission. Drivers, who for whatever reason enter the area used for the Barum Czech Rally Zlín during that period, must promptly inform the Clerk of the Course (J. Regner, tel.: +420 577 432 004).

9.3.3 Reconnaissance is restricted in **2 passes** in the same special stage. On the SSS 1 - SSS Zlín only 1 passage (3 laps) is allowed. Crews are forbidden to drive in the opposite direction to that of the special stages, except of route areas specified in the reconnaissance road book.

Control will be done by GPS tracking and rally officials, who will observe and control Reconnaissance on place.

9.3.4 The progress of the reconnaissance will be monitored via GPS system, by the Czech police and other rally officials. The maximum speed limitations during reconnaissance follow the Czech traffic regulations. Breaking the rules and mainly exceeding the speed limits will be controlled and fined by the Czech police according to standard procedures. Evaluation the GPS data is within the competence of Clerk of the Course. If there will be found that the reconnaissance vehicle is not equipped with working tracking system, the crew will be reported to the stewards.

Returning reconnaissance GPS units in Stop of SSS 1 Zlín

Place: Zlín, Zarámí street

Date: 14.8. 2025 (from 23:30 - 01:15)

9.3.5 Driving conduct

Competitors must follow Art. 34 of FIA RRSR

Illegal reconnaissance performed out of the time schedule or performing more passages than permitted will be reported to the stewards.

Speeding during reconnaissance and during the rally will incur a fine applied by the clerk of the course as follows:

Per km per hour over the speed limit: **€25**

- Other traffic infringements during reconnaissance will incur a fine applied by the Stewards.
- The amount of the fines will be unaltered by any fine imposed by the police.
- The fine will be doubled in case of a second offence committed during reconnaissance in the same rally.

Penalties for infringements during the competition element of the rally:

- a) First infringement:
 - Speeding: A fine of €25 per km over the speed limit, applied by the clerk of the course,
 - Other than speeding: A penalty will be applied by the Stewards.
- b) Second infringement:
 - Speeding: A fine of €50 per km over the speed limit, applied by the clerk of the course,
 - Other than speeding: A penalty will be applied by the Stewards.
- c) Third infringement: A 5-minute time penalty applied by the clerk of the course.
- d) Fourth infringement: Disqualification applied only by the Stewards.

9.3.6 Any testing from Wednesday 13. 8. 2025 in Zlín region (Zlínský kraj) is prohibited for Barum Czech Rally Zlín entrants. Testing is restricted according to RRSR V1 Art. 68.4

10. ADMINISTRATIVE CHECKS

10.1. Documents to be presented

It is mandatory to send all requested documents in advance to email entry@czechrally.com.

Crews are obliged to make administrative check before their time for scrutineering.

Documents to be sent:

- Competitor and drivers' licences
- Valid Driving licences
- ASN authorisation (mandatory for all foreign competitors)
- Driver's declaration and undertakings forms, signed by the driver and the co-driver
- Car insurance cover certificate and car insurance registration papers (green card)
- First page of homologation sheet
- Authorization of the car owner in case he is not one of the drivers
- Safety E-learning – valid certificate of driver and co-driver

Documents to be checked on administrative checking:

- Competitor and drivers' licences
- Valid Driving licences will be checked when collecting reconnaissance material
- Signed entry form (competitor and entrant)

Notwithstanding the 2025 FIA-RRSR, Art. 30.1, drivers and co-drivers are not required to report personally to the Administrative Checks. Each Competitor shall nominate in advance to the Organiser one authorised representative to complete the Administrative Checks

10.2. Timetable

Optional administrative check

Place: Permanent secretariat Barum Czech Rally Zlín
AK Barum, Hornomlýnská 3715, 760 01 Zlín

Date: 13. 8. 2025 Time: 08:00 - 13:00

Administrative checks

Place: Rally HQ – Building 21, Zlín

Date: 14. 8. 2025

Time: 12:30 - 21:30

11. SCRUTINEERING, MARKING AND SEALING

11.1 Scrutineering

Place: Otrokovice (Building at the place of Service Park Exit)

Date: 14. 8. 2025 Time: 13:30 - 22:30

The time for scrutineering will be published as Bulletin on official website/DNB of the rally. Any delay or early arrival at scrutineering will be penalised by 40 € for each 5 minutes. If the delay exceeds 30 min the crew will be reported to the Stewards.

The team must bring also technical card confirmed from administrative check.

11.2 Marking and sealing

According to the FIA 2025 ERC Sporting Regulations:

- All FIA and ERC priority drivers must seal their transmissions and spares.
- All cars must have engine block marked.
- All cars equipped with turbocharger and their spares must be marked.

After pre-rally scrutineering, any change of sealed component must be notified by the competitor to the following e-mail: erc-technical@fia.com. This notification must be received prior to the change of part.

11.3 Mud Flaps

Fitting and use of mud flaps, comply with Art. 252.7.7 of FIA Appendix J, is permitted but not compulsory.

11.4 Windows / Nets

According to Appendix J Art. 253.11, the use of silvered or tinted films is authorized, on the rear side windows, on the rear window and the sunroof. Silvered or tinted films fitted on rear side windows must have an opening equivalent to the surface of a circle of 70 mm in diameter.

11.5 Driver's Safety Equipment

Competitors must present all the items of protective clothing, which will be used including underwear, helmets and FIA approved head restraint (FHR system, formerly called HANS) Compliance will be checked with Appendix L Chapter III and with technical regulations. See Appendix 5 of these Supplementary regulations.

11.6 National Regulations

All vehicles must comply with art. 4.3.2 of these Supplementary Regulations

11.6.1 Outside noise level of cars

All cars must be equipped with the stable exhaust silencer. The outside noise level measured by stationary method may not exceed 96 dB/A for all cars with the margin of error plus 2 dB/A. The noise level will be measured at 3500 revs/min. in petrol engine cars and at 2500 revs/min. in diesel engine cars according to EHK Regulations 51.02.

Noise level will be measured during scrutineering and eventually at any point during the rally. Any exceeding of noise limit during scrutineering results in start refusal, any exceeding of noise limit in the course of the rally will be reported to the Stewards who may apply sanctions according to the art. 12 of the FIA International Sporting Code.

11.6.2 Catalytic converters

All vehicles must be obligatory equipped by homologated catalytic converter.

For missing, incomplete, or ineffective catalytic converters identified during scrutineering, the crew shall be refused a start. A car with a missing or incomplete catalytic converter during rally shall be reported to the Stewards, who may impose penalty in accordance with art. 12 of the FIA International Sporting Code.

11.6.3 Car lighting

In liaison road sections between special stages, it is possible to use car lighting only through the original fitted and auxiliary headlamps with EHK ("E") homologation. Headlamps without homologation cannot be used during connection road sections. Complying with this provision will be checked by judges of fact. Any infringement will be reported to the Stewards who may impose sanctions complying art. 12 of the FIA International Sporting Code.

11.7 Obligatory monitoring device (GPS)

11.7.1 The GPS tracking system will be rented to the competitors. Eventual destruction, non-return or damage of the unit has to be paid for by the competitor to the provider. All further details are given in Appendix 6 SR and will be published on www.czechrally.com

11.7.2 Each car in the rally must be equipped with the GPS monitoring unit before the scrutineering.

11.7.3 The competitors will receive the GPS parts from administrator of GPS devices together when road books are collected, and they must install them in their cars in compliance with the given installation manual before scrutineering.

11.7.4 Competition cars not equipped with the monitoring device GPS will not be allowed to start.

11.7.5 Any attempt to tamper with, to manipulate or to interfere with the tracking device fitted to the competition car or any device that fails to record a trace due to external interference will be reported to the Stewards who may impose a penalty up to exclusion.

The GPS Monitoring system ONI will be used for reconnaissance for all drivers
GPS tracking system STATUS AWARENESS SYSTEM (SAS) for the rally for all drivers

Wednesday, 13. 8.

08:00 – 13:00	Distribution of the road book and GPS units for the reconnaissance (All drivers)	AK Barum
08:00 – 13:00	Distribution of onboard camera stickers (ERC starting field)	AK Barum
08:00 – 13:00	Distribution GPS for the rally	AK Barum

Thursday, 14. 8.

13:00 – 22:30	Scrutineering of the cars, marking and sealing	Otrokovice
23:30 - 01:15	Returning reconnaissance GPS units in Stop of SSS 1 Zlín	Zlín, Zarámí street

Sunday, 17.8.

21:45	Deadline for returning GPS unit	SAS tent at parcferme
-------	---------------------------------	-----------------------

11.7.6 Dismantling of the GPS SAS monitoring system

One mechanic is allowed to help the crew with unmounting the monitoring device GPS in the area between TC 13C and Parc Fermé under the supervision of a Scrutineer.

11.7.7 Operation during events on SS is described in Appendix 6 SR.

12. OTHER PROCEDURES

12.1 Start procedure and order

12.1.1 Start of the rally

On the DNB (in given times according to SR Program) there will be published starting order for:

Name	TC	Description	Start order
Ceremonial start		Starting order according to starting numbers. First ten crews in 2 minutes interval and the rest in 1 minute.	ERC, CRC
Start for Sect.1 of Leg 1	TC 0	Reversed starting order in 1 minute interval.	CRC, ERC
Start for Section 2 of Leg 1	TC 1B	<ul style="list-style-type: none"> - all FIA, ERC1 priority drivers will start according results of qualifying stage complying RRSR V1A, article 37.6 in 2 minutes interval - after ERC3 priority drivers will start according to starting numbers in 1 minute - after ERC4 priority drivers will start according to starting numbers in 1 minute - the rest of drivers in 1 minute according to their starting numbers. 	ERC, CRC
Start for Leg 2	TC 7E	<ul style="list-style-type: none"> - The first 15 ERC1 Priority Drivers in the partial classification will re-start as a merged group in reverse order according to their classification in 2 minutes interval (other drivers in one minute), followed by the remaining ERC1 Priority Drivers, ERC3 Priority Drivers, ERC4 Priority Drivers. - All other drivers shall normally re-start in the order of their classification 	ERC, CRC

Time cards will be delivered in administrative check. Collecting during the rally will be in time controls TZ, 1, 1A, 3A, 4A, 6A, 7A, 7D, 9A, 10A, 12A, 13A, 13B a 13C

12.1.2 Ceremonial start

The competing cars are summoned to enter holding area before ceremonial start not earlier than **20 minutes** before individual starting time. Crews must wear racing overalls and attend the ceremonial start with their competition cars. If any crew is unable to participate in the ceremonial start because of technical problems with their car, they will be permitted to start into the Leg 1 at TC 0 in its allocated start time on condition of notification to the Clerk of the Course and passing the obligatory re-scrutineering checks. The concerned crew must attend the ceremonial start wearing overalls at their due time anyway.

12.1.3 Start of the rally

The crews will start in reversed starting order in 1 minute interval (from the highest to the lowest starting numbers) according to the starting list posted on the DNB (First will start Czech Rally Championship, followed by ERC). Parc Fermé before the start at TC 1 will not be organised. The crews will arrive to TC 1 according to the detailed map in the road book.

Tyre marking zone will be located after TC 1.

12.1.4 Restart after retirement

Any crew which has failed to complete Leg 1 may be assumed to re-start the rally from the start of the next Leg, unless they confirm otherwise in writing to the clerk of the course. For new start the condition according to the art. 54 and 55 FIA RRSR must be followed. If the car retired due to an accident, before any repair, the vehicles may be brought directly to their service area and wait under Parc Fermé condition until the FIA Technical Delegate gives authorisation to repair it. The car must return to the overnight Parc Fermé prior to the next Leg no later than 1 hour before the scheduled start of Leg 2.

Penalties for retired Crews in Leg 1

For all crews which retire a time penalty will be applied according to the art. 54 FIA RRSR. This time penalty will be 10 minutes for every stage missed in Leg 1. This time penalty will be added to the fastest time of the car's class for each missed stage, which shall include the special stage on which the crew has retired.

Should retirement occur after the last special stage before an overnight regroup, the crew will nonetheless be deemed to have missed that last special stage.

For super special stage SSS 1 Zlín see the article 12.4.2 of SR.

12.1.5 Start of special stages

The start to all special stages except SSS 1 and SS 2/5 will be given by an electronic digital countdown system, counting down by seconds and clearly visible to the crew from the start position and electronically coupled to a start line detection device that records any situation where a car leaves the start line ahead of the correct signal. This start line detection device is 50 cm after the start line in the height of 50 (+/- 5) cm. The car must be placed in such a way that its foremost part is on the level of the start line.

Timekeeper gives the time card to the crew as late as in the minute of starting procedure.

Light signals combined with digital countdown system will be used:

Countdown:

5 seconds to GO: 1 red line above the time

4 seconds to GO: 2 red lines above the time

3 seconds to GO: 3 red lines above the time

2 seconds to GO: 4 red lines above the time

1 seconds to GO: 5 red lines above the time

0 seconds - START: all red lines above the time are replaced by one big green line

after "start": 20 seconds after start is displayed one big green line above the time



In case of electronic digital countdown system breakdown, the car will be started on the instruction given by the timekeeper

12.2 Finish procedure

The competition part of the rally ends in the Time Control at the entrance to the Parc Fermé (TC 13C). First three crews of the rally will be awarded, other prizes according to the art. 66.2 will be given on the finish ramp. After the ceremonial, crews will get the time card and they are obliged to go straight to the Parc Fermé (Zlín, next to Rally HQ).

Attention: Crews that are not interested to pass the finishing ramp, obtain the winning cups and metal medals of Barum Czech Rally Zlín (all the participants of the rally obtain medal for finishing the rally), are allowed to drive from TC 13A straight to TC 13B according to the road book and then continue to TC 13C Parc Fermé.

12.3 Permitted early check-in

Early arrival without penalty is permitted only at TC TZ (Otrokovice), TC 1A (Parc Fermé Zlín), TC 7C (Flexi Service out), TC 7D (Parc Fermé Zlín), TC 13A (Street Bartošova), TC 13B (City square) and 13C (Parc Fermé).

12.4 Special stages

12.4.1 Shakedown / Free Practice / Qualifying stage (15.8.2025 08:00 – 13:00)

Only competitors, who passed administrative check and scrutineering, can automatically participate in Shakedown (no registration needed), Free practice and Qualifying stage. Competition numbers and advertising stickers must be affixed to their cars. It is compulsory to wear the safety equipment of driver and co-driver as for normal SS.

For the shakedown only, If there is a person, by exception, not rally participant, this person must have an approval from the Clerk of the Course and this person must together with the competitor declare and sign a disclaimer of responsibility – the form will be available at the administrative check and the shakedown start.

The crew whose car breaks down during the shakedown / Free Practice / QS shall nevertheless attend the ceremonial start in comply with article 12.1.2. SR

Tyre marking zone will be located between the TC QS and the Start QS.

Only tyres on rally car for Qualifying stage will be marked (spare wheel will not be marked).

Tyres for Free practice and Shakedown are not counted for the overall quantity.

Priority ERC drivers are allowed to participate in shakedown after QS.

12.4.2 Circuit special stages: SSS 1 - SSS Zlín (15. 8. 2025 at 21:15)

The crews will start in reversed starting order in 1 minute interval (from the highest to the lowest starting numbers) according to the starting list posted on the DNB (First will start Czech Rally Championship, after ERC).

The crews will arrive to the SSS starting area according to the detailed map in the road book. SSS 1 will be organized with details given in rally time schedule, in the road book and in the time card. Time results will be counted to the overall classification including eventually penalty that will be given according to regulations for special stages.

Start of the SSS 1 will be flying, it means the crew starts to the special stage on green signal light (or other wave given by the start marshal) and the exact flying starting time will be recorded by the start detection device placed 1 m after the start line. Finish photocell is placed in circuit part of SSS 1 Zlín. Exact placement described in road book.

If the start will be done in expected starting interval (approx. 1 minute), timekeeper will show a board with number 5 approx. 5 seconds before green light appears on a semaphore. In case of longer delay than expected, timekeeper will show the board with a sign STOP and then show again the board with number 5 approx. 5 seconds before green light appears on the semaphore. Start at the red light is prohibited!

Crews that will not finish SSS or retire during Section 1, crews which will do less than required number of laps or whose SSS time is worse than 12 minutes will receive an allocated SSS time of 12 minutes. The retired crews can restart into the Section 2 under the condition of Art. 12.1.4 of SR and that the car is placed to the Parc Fermé 1 hour before.

12.4.3 SS 2/5 – Březová

Start of the stage will be flying, it means the crew starts to the special stage on green signal light (or other wave given by the start marshal) and the exact flying starting time will be recorded by the start detection device placed after the start line.

If the start will be done in expected starting interval (approx. 1 minute), timekeeper will show a board with number 5 approx. 5 seconds before green light appears on a semaphore. In case of longer delay than expected, timekeeper will show the board with a sign STOP and then show again the board with number 5 approx. 5 seconds before green light appears on the semaphore. Start at the red light is prohibited!

Crews, which do less number of laps, will be excluded and can re-start the following leg. Crews, which will do higher number of laps, will get the real counted time. Laps will be counted by the judges of fact. Crews that will not finish the SS will be considered as retired and can restart into Leg 2 according to SR, article 12.1.4.

12.4.4 Chicanes

Due to safety reasons, barriers will be positioned on the rally route. The judges of fact will be appointed for each chicane to report any incorrect passing. The judges of fact will be published in a Bulletin on the Official notice board in compliance with the art. 11.16 of ISC. Chicanes will be formed with straw bales.

Any incorrect passing of a chicane will be recorded by the judge of the fact on the control sheet and reported to the Clerk of the Course, who will penalize the crew.

Penalties:

- overturning or moving one element of the chicane outside the base or if the car touches the straw bale so that the judge of the fact or marshal needs to touch it to get it back to position. It is incorrect passing. **10 seconds for each**
- bypassing, going around or skipping a chicane **will be reported to the Stewards**

Moving part of the chicane is understood to be the state when the bale moves from its painted base (circle). Overturning the bale is considered to be moving outside of the base.

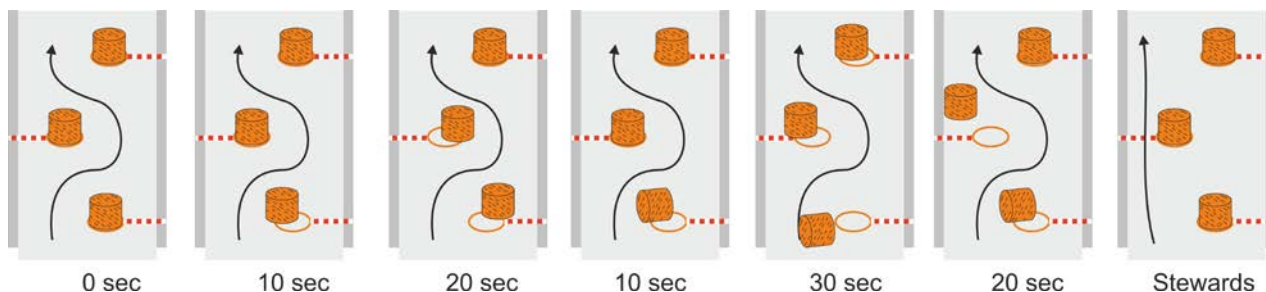

Traffic sign “Z4” will be used as spare part of the chicane in case of destroying the strawbale.

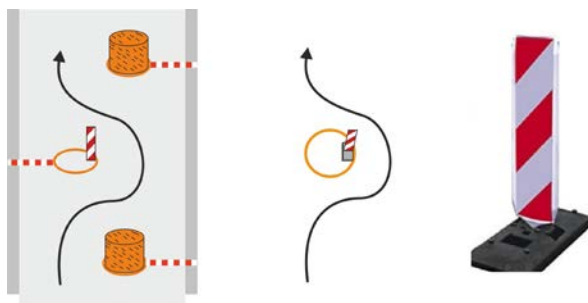

12.5 Service Parks

12.5.1 Location and organisation of service parks

Place: Otrokovice, area of Continental Barum spol. s r.o. (A, B, C, D, E)
 Date (Time): **Wednesday, 13. 8.** Early entry to Service Park is possible for fee **100 € ***
 (17:00 – 21:00) (for free for official pre-event test participants only)

Thursday, 14. 8. Opening of service area
 (from 08:00)

* On Wednesday, only service cars (vans and trucks) with correct sticker issued in administrative checking can enter to a part of service area (Continental Barum testing track) only for parking the truck in the designated place for the team. It is forbidden to do any work (unloading cars, building tents, work on the cars). Any infringement will be penalised by penalty 300 € by Clerk of the Course.

A limitation for servicing, refuelling and changes of mechanical parts is introduced in Art. 56 of FIA RRSR Service parks A, B, C, D, E can be entered only with Service car (SERVICE). Auxiliary vehicles are not allowed to enter the Service Park. Further details concerning the entrance of service and auxiliary vehicles are given in the Service Road Book.

Service for shakedown, Free Practice and Qualifying stage: Otrokovice, area of Continental Barum spol. s r.o. (any service out of the Service Park is prohibited!)

Service parks

Service	Location	Duration
Leg 1, Saturday		
A	Otrokovice	15'
B	Otrokovice	30'
C	Otrokovice	45'
Leg 2, Sunday		
D	Otrokovice	15'
E	Otrokovice	30'

Allocation of working areas

Competitors will be allotted by the organizers their working areas inside the service park as follows:

- to each team registered in FIA ERC1 will be allotted an area of 150 m² for one car team and 200 m² for two car team or shared among its team. 50 square meters for each additional car.
- to each team registered in FIA ERC3 will be allotted an area of 100 m² for one car team and 50 square meters for each additional car.
- to each team registered in FIA ERC4 and Junior ERC will be allotted an area of 90 m² for one car team and 50 square meters for each additional car.
- to other drivers will be allotted an area of 80 m²

Additional space can be ordered for a price of 30 € per 1 m²

Connection to electricity in the service area Otrokovice can be arranged only after preliminary agreement

Driving in Service Park

During the service time between the first rally car enters and the last car leaves the service park, it is strictly forbidden for all service vehicles to enter or drive inside the service park. Every infringement will be reported to the Stewards. Service Park is one-way both for rally cars as well as the service and auxiliary vehicles. Maximum speed inside the service park is limited by 30 km/h.

Times of restriction of movement in Service Park

Service Otrokovice	Times of restriction	Details
A	16. 8. 2025, 07:45 - 09:45	not allowed
B	16. 8. 2025, 13:20 - 15:20	service only for remote refuelling
C	16. 8. 2025, 18:40 - 20:40	not allowed
D	17. 8. 2025, 06:45 - 08:45	not allowed
E	17. 8. 2025, 11:55 - 13:55	service only for remote refuelling

12.5.2 Flexi service (Service C, 16 August 2025)

ATTENTION: After the Flexi Service, the vehicles must be taken to the Overnight Parc Fermé on the public road. Therefore, only the crews are allowed to drive the vehicles.

For the operation of 45' flexi-servicing, crews will enter the Regroup (Parc Fermé). Crews may then either enter the service park or leave their car in the Regroup (Parc Fermé). The competing car may be driven only by crew and only once from the Regroup (Parc Fermé) to the service park and to the Overnight Parc Fermé. The competition vehicle may leave the service park (TC7C) before the 45 minutes have elapsed and check-in early in TC7D (Overnight Parc Fermé).

All cars except re-starting cars have to be in the overnight Parc Fermé no later than at 23:00.

12.5.3 Catering in service area

If your team or any other company would like to have a catering for their guests in service area, it must be settled with organiser before starting administrative checking. In other cases organisers can forbid this catering. Exception is food-supply for crews and mechanics. Regarding the waste disposal organiser can levy a charge for costs. Selling food and drinks in service area without permission of organisers is strictly forbidden.

12.5.4 Shows and exhibitions in service area

If any team or company would like to organise shows or exhibitions for their guests in service area, they must ask organisers for permission before administrative check. All shows and exhibitions in service area without permission of organisers are strictly forbidden.

12.6 Entrance to the regrouping area and Parc Fermé

12.6.1 Safety GPS tracking technicians are allowed to enter the regrouping area and Parc Fermé to maintain or repair the GPS tracking systems installed in the rally cars. They have to be accompanied by scrutineer and at least one representative of the team.

12.6.2 TV Crews are allowed to enter the regrouping area and Parc Fermé to maintain the camera systems installed in the rally cars or to exchange the data recording media. They have to be accompanied by scrutineer and at least one representative of the team.

12.7 Official time used during the rally

Official time throughout the rally is that of the GPS. The time zone is the Central European Summer Time (CEST) (UTC +2).

12.8. ARTIFICIAL INTELLIGENCE SAFETY CAMERA (AISC)

In 2025 European Rally Championship season FIA will use AI Safety Cameras to improve the safety of active stage. It is mandatory to carry the camera system by the crews nominated by FIA and published by Bulletin. The teams of the nominated crews will be invited to a meeting in which the operation of the system will be explained and shown. The invitations to the meeting will be individually send to the teams. If necessary, the system can be installed during the event in any other car than originally nominated. In such case team of the crew concerned will be contacted and the function of the AISC will be introduced.

12.9. PROMOTER PORTRAIT FOR COMPETITORS ERC

Photos will be taken in the Media Centre of the Barum on Thursday, 14th August 2025 between 19:00 and 20:15. This is for all ERC registered competitors taking part in their first ERC event of 2025.

Participants should note the following:

- Photos will be taken on a first-come, first-served basis.
- The photo shoot is compulsory for all drivers and co-drivers, but more importantly, it will provide valuable material for the 2025 season, which will be used for promotion in print, online and on social media.
- Please come to the photo shoot in your official race suit, shoes and gloves (if applicable).

13. IDENTIFICATION OF OFFICIALS

Chief of SS	- red tabard
Chief of TC	- red tabard
Chief of RCP/ SP	- yellow tabard with radio-sign (flash)
Timekeeper	- yellow tabard or green armband with inscription "Časoměřič / Timekeeper"
Scrutineer	- black tabard with inscription "Scrutineer"
Route Marshals	- orange tabard
CRO	- redtabard with inscription "Competitor's Relations Officer"

14. CLASSIFICATION AND PRIZES

14.1.1 FIA Championship classifications

FIA European Rally Championship for Drivers and Co-Drivers
 FIA European Rally Championship for Teams
 FIA European Rally Championship for Tyre Suppliers
 FIA ERC 3 Championship for Drivers and Co-Drivers
 FIA ERC 4 Championship for Drivers and Co-Drivers
 FIA Junior ERC Championship for Drivers
 FIA Master ERC Championship for Drivers

14.1.2 Other classifications

M-Sport Fiesta Rally3 Trophy

14.1.3 ASN classifications

Autoklub Czech Rally Championship
 Autoklub Rally Challenge
 Autoklub Czech Junior Championship
 Czech Ladies' Trophy
 Cup 55+

Toyota Yaris Cup Czech

14.1.4 Classifications will be established following the FIA RRSR.

14.2 Prize-giving

Place: Zlín, Náměstí Míru square, in front of the town hall

The prize-giving will take place on 17. 8. 2025 at 17:30. The ownership of cups over given to winners will be confirmed after the official final classification. Following souvenir trophies will be awarded for:

14.2.1 FIA European Rally Championship for Drivers and Co-Drivers

1 st place	cups, challenge cup
2 nd place	cups
3 rd place	cups

14.2.2 FIA European Rally Championship for Teams:

1 st place	Cup
-----------------------	-----

14.2.3 FIA ERC3 Championship for Drivers and Co-Drivers

1 st place	cups
2 nd place	cups
3 rd place	cups

14.2.4 FIA ERC4 Championship for Drivers and Co-Drivers

1 st place	cups
2 nd place	cups
3 rd place	cups

14.2.5 FIA Junior ERC Championship for Drivers

1 st place	cups
2 nd place	cups
3 rd place	cups

14.2.6 FIA Master ERC Championship for Drivers

1 st place	cups
2 nd place	cups
3 rd place	cups

14.2.7 FIA European Rally Championship for Tyre Suppliers

1 st place	cup
-----------------------	-----

14.2.8 M-Sport Fiesta Rally3 Trophy

1 st place	cups
2 nd place	cups
3 rd place	cups

14.2.9 Barum Czech Rally Zlín Ladies' Trophy

1 st place	cups
2 nd place	cups
3 rd place	cups

14.2.10 Barum Czech Rally Zlín in classes RC3, RC4, RC5 and RGT

1 st place	cups
2 nd place	cups
3 rd place	cups

15. FINAL CHECKS / PROTESTS / APPEALS

15.1. Final scrutineering of selected vehicles

Place: Samohýl Motor Zlín, a.s., Tř. Tomáše Bati 642, 763 02 Zlín
 Date: 17. 8. 2025
 Time: 18:30

Any teams required to undergo final scrutineering must immediately follow the instruction of the marshals in charge, even if this prevents them from proceeding to one or more time controls (TC). The complete original FIA homologation form and other necessary certifications must be available for final scrutineering. A representative of the competitor as well as mechanics with the appropriate tools (in case of dismantling) must be present at the final scrutineering.

15.2 Protest or petition for review deposit

The protest or petition for review deposit is: EUR 1.000 (to be paid in cash or by bank transfer)

If the deposit is made by bank transfer, the protest must be accompanied by a proof of payment. Failing this, or should the Stewards consider that the proof of payment is not satisfactory, the protest shall not be admissible.

The relevant bank account details are:

Crédit du Nord
 50, rue d'Anjou
 F-75008 PARIS
 Banking code: 30076
 Counter code: 02020
 Account number: 25368000200 key RIB 34
 IBAN code: FR 76 3007 6020 2025 3680 0020 034
 Swift code: NORDFRPP

15.3 Appeal deposit

The appeal deposit for an international appeal is: EUR 3.000,00

All protests and/or appeals must be lodged in accordance with Articles 13 and 15 of the Code and, where applicable, with the FIA Judicial and Disciplinary Rules.

15.4 Fines

In accordance with Article 12.8 FIA International Sporting Code, the payment of the fines must be done online, within 48 hours of their notification, at the following address: <https://fiafines.fia.com>
Any delay in making payment may entail Suspension during the period a fine remains unpaid.



Jan Regner
Clerk of the Course
Barum Czech Rally Zlín

Appendix 1

Itinerary

BARUM CZECH RALLY ZLÍN

15. - 17. 8. 2025

powered by Continental

Qualifying stage / Kvalifikační RZ (Sunrise: 5:41, Sunset: 20:05)							Friday 15 August 2025
SS/RZ TC/ČK	Location Místo	SS distance RZ délka	Liaison dist. Trať bez RZ	Total dist. Spoj. úsek	Target time Jízdní doba	Av. Speed Prům. rychlost	First car due Čas I. jezdce
TC FP Free Practice / Volný trénink							from 8:00 to 9:18
TC QS Komárov							9:26
QS Komárov		7,61					9:31
TC TZ Technical Zone in (Early check-in permitted)			5,46	13,07	0:25	31,37	9:56
Shakedown							from 10:15 to 13:00

LEG 1, Section 1 (Sunrise: 5:41, Sunset: 20:05)							Friday 15 August 2025
SS/RZ TC/ČK	Location Místo	SS distance RZ délka	Liaison dist. Trať bez RZ	Total dist. Spoj. úsek	Target time Jízdní doba	Av. Speed Prům. rychlost	First car due Čas I. jezdce
Ceremonial Start - Zlín (City square / náměstí Míru)							16:00
1	Zlín (Vodní) & Technical Zone						22:15
1	SSS ZLÍN (3 laps)	9,57			0:05 (+2 min)		22:20
1A	Parc Fermé - Zlín (Next HQ / pod Velkým kinem) (Early check-in permitted)		1,43	11,00	0:30	22,00	22:50

Section 1

Leg 1 (Section 1) totals	9,57	1,43	11,00
---------------------------------	-------------	-------------	--------------

V1 - 15.05.2025

LEG 1, Section 2-5 (Sunrise: 5:42, Sunset: 20:03)

Saturday 16 August 2025

SS/RZ TC/ČK	Location Místo	SS distance RZ délka	Liaison dist. Trať bez RZ	Total dist. Spoj. úsek	Target time Jízdní doba	Av. Speed Prům. rychlost	First car due Čas 1. jezdce
1B	Re-start Leg 1 / Zlín (Next HQ / pod Velkým kinem)						7:30
1C	Service in		10,64	10,64	0:25	25,54	7:55
	Service A (Otrokovice)	(9,57)	(12,07)	(21,64)	0:15		
1D	Service out						8:10
	R.Z. 1 Refueling Zone	(12,73)	(46,18)	(58,91)			
2	Nové Dvory		34,13	34,13	0:50	40,96	9:00
2	Březová 1	12,73			0:03		9:03
	R.Z. 2 Remote Refuel Zone Zlín	(35,78)	(91,24)	(127,02)	12,05 km after fly finish of SS Březová		
3	Halenkovice		42,14	54,87	1:15	43,90	10:18
3	Halenkovice 1	17,67			0:03		10:21
3A	Regrouping & Technical Zone in		20,51	38,18	0:55	41,65	11:16
	Regrouping (Velehrad)				0:20		
3B	Regrouping out						11:36
4	Salaš		6,39	6,39	0:15	25,56	11:51
4	Bunč 1	18,11			0:03		11:54
4A	Regrouping & Technical Zone in		34,25	52,36	1:05	48,33	12:59
	Regrouping (Otrokovice)				0:30		
4B	Regrouping out, Service in						13:29
	Service B (Otrokovice)	(48,51)	(137,42)	(185,93)	0:30		
4C	Service out						13:59
	R.Z. 3 Refueling Zone	(12,73)	(46,18)	(58,91)			
5	Nové Dvory		34,13	34,13	0:50	40,96	14:49
5	Březová 2	12,73			0:03		14:52
	R.Z. 4 Remote Refuel Zone Zlín	(35,78)	(91,24)	(127,02)	12,05 km after fly finish of SS Březová		
6	Halenkovice		42,14	54,87	1:15	43,90	16:07
6	Halenkovice 2	17,67			0:03		16:10
6A	Regrouping & Technical Zone in		20,51	38,18	0:55	41,65	17:05
	Regrouping (Velehrad)				0:15		
6B	Regrouping out						17:20
7	Salaš		6,39	6,39	0:15	25,56	17:35
7	Bunč 2	18,11			0:03		17:38
7A	Parc Fermé & Technical Zone in		34,25	52,36	1:05	48,33	18:43
7B	Parc Fermé out / Flexi Service in				0:10		18:53
	Flexi Service C (Otrokovice)	(48,51)	(137,42)	(185,93)	0:45		
7C	Flexi Service out (Early check-in permitted)						19:38
	R.Z. 5 Refueling Zone	(0,00)	(24,49)	(24,49)			
7D	Parc Fermé - Zlín (Next HQ / Pod Velkým Kinem) (Early check-in permitted)		13,85	13,85	0:35	23,74	20:13
	All Cars (except re-starting crews) to be in Parc Fermé no later than						23:00

Section 2

Section 3

Section 4

Section 5

Leg 1 totals

106,59

300,76

407,35

V1 - 15.05.2025

LEG 2, Section 6-9 (Sunrise: 5:43, Sunset: 20:01)**Sunday 17 August 2025**

SS/RZ TC/ČK	Location Místo	SS distance RZ délka	Liaison dist. Trať bez RZ	Total dist. Spoj. úsek	Target time Jízdní doba	Av. Speed Prům. rychlost	First car due Čas 1. jezdce
7E	Start Leg 2 / Zlín (Next HQ / pod Velkým kinem)						6:30
7F	Service in		10,64	10,64	0:25	25,54	6:55
	Service D (Otrokovice)	(0)	(24,49)	(24,49)	0:15		
7G	Service out						7:10
	R.Z. 6 Refueling Zone	(17,22)	(38,78)	(56,00)			
8	Želechovice		34,14	34,14	0:50	40,97	8:00
8	Pindula 1	17,22			0:03		8:03
	R.Z. 7 Remote Refuel Zone Slušovice	(33,23)	(82,90)	(116,13)	4,64 km after fly finish of SS Pindula		
9	Kašava		18,74	35,96	0:50	43,15	8:53
9	Podhoran 1	20,61			0:03		8:56
9A	Regrouping & Technical Zone in		11,30	31,91	0:40	47,87	9:36
	Regrouping (Ratiboř)				0:16		
9B	Regrouping out						9:52
10	Kateřinice		4,76	4,76	0:10	28,56	10:02
10	Kateřinice 1	12,62			0:03		10:05
10A	Regrouping & Technical Zone in		52,74	65,36	1:25	46,14	11:30
	Regrouping (Otrokovice)				0:36		
10B	Regrouping out, Service in						12:06
	Service E (Otrokovice)	(50,45)	(121,68)	(172,13)	0:30		
10C	Service out						12:36
	R.Z. 8 Refueling Zone	(17,22)	(38,78)	(56,00)			
11	Želechovice		34,14	34,14	0:50	40,97	13:26
11	Pindula 2	17,22			0:03		13:29
	R.Z. 9 Remote Refuel Zone Slušovice	(33,23)	(74,80)	(108,03)	4,64 km after fly finish of SS Pindula		
12	Kašava		18,74	35,96	0:50	43,15	14:19
12	Podhoran 2	20,61			0:03		14:22
12A	Regrouping & Technical Zone in		11,30	31,91	0:40	47,87	15:02
	Regrouping (Ratiboř)				0:50		
12B	Regrouping out						15:52
13	Kateřinice		4,76	4,76	0:10	28,56	16:02
13	Kateřinice 2 - Power Stage	12,62			0:03		16:05
13A	Zlín (Street / ulice Bartošova) (Early check-in permitted)		43,15	55,77	1:15	44,62	17:20
	Prize Giving / Vyhlášení (City square / náměstí Míru)						(17:30)
13B	Zlín (City square / náměstí Míru) (Early check-in permitted)		0,35	0,35			
13C	Parc Fermé - Zlín (Next HQ / pod Velkým kinem) (Early check-in permitted)		1,14	1,14	(0:10)		

Section 6

Section 7

Section 8

Section 9

Leg 2 totals**100,90****245,90****346,80****V1 - 15.05.2025****RALLY TOTALS**

Leg Etapa	No. of SS Počet RZ	SS dist. RZ délka	Liaison dist. Trať bez RZ	Total dist. Délka celk.	Percentage Procenta
1	7	106,59	300,76	407,35	26,17%
2	6	100,90	245,90	346,80	29,09%
Overall Totals	13	207,49	546,66	754,15	27,51%

Appendix 2

Reconnaissance schedule

Wednesday 13.8.2025

RZ	Special stage	ERC Priority Drivers (from - to)	Other drivers (from - to)
9/12	Podhoran	12:00 17:00	13:00 18:00
10/13	Kateřinice	13:00 18:00	12:00 17:00
FP/QS/SD	Komárov	12:00 18:00	12:00 18:00

Thursday 14.8.2025

RZ	Special stage	ERC Priority Drivers (from - to)	Other drivers (from - to)
2/5	Březová	08:00 16:00	11:00 19:00
8/11	Pindula	08:00 16:00	11:00 19:00
3/6	Halenkovice	11:00 19:00	08:00 16:00
4/7	Bunč	11:00 19:00	08:00 16:00
1	SSS Zlín *	23:15 24:00	24:00 01:00

* Time of each Crew for the reconnaissance of SSS 1 will be published on internet and will be over given when collecting the road books for Recce, see SR article 9.1.

Wednesday 13.8.2025

Distribution of road book, monitoring GPS unit for the reconnaissance and recommended Administrative check

Wednesday 13.8. and Thursday 14.8.2025

Reconnaissance according to the schedule

Appendix 3

CROs – names, photographs and duties schedule

The principal duty of the CRO is to provide information or clarifications in connection with the regulations and the running of the rally to the competitors/crews. There must be at least one at each rally who must be easily identified by the competitors or crews and shall be present according of the CRO schedule.

We are Competitor's relations officers:



Wolfgang Gastorfer
(GER, GBR, SWE)



Veronika Havelková
(CZE, GBR)

Competitors Relations Officers will be available via phone, SMS, WhatsApp during the whole rally. Mobile phones of CROs will be published by the Notification of CoC.

Schedule of CROs' duties

Thursday, 14. 8. 2025

Administrative checks - Zlín, Rally HQ
Scrutineering – Otrokovice, Service Park

Friday, 15. 8. 2025

Free Practice/ Qualifying stage / Shakedown
Ceremonial start of the rally - Zlín, city square
Start of Section 1 (Leg 1) - TC 0, Zlín, Vodní street
Finish of Section 1 (Leg 1) - TC 1A, Zlín, next to Rally HQ

Saturday, 16. 8. 2025

Start for Section 2 (Leg 1) - Zlín, next to Rally HQ
Regrouping (Velehrad)
Regrouping (Otrokovice), Service (Otrokovice)
Posting of the starting order for Leg 2 – Zlín, Rally HQ

Sunday, 17. 8. 2025

Regrouping (Ratiboř)
Regrouping (Otrokovice), Service Otrokovice
Rally finish - Zlín, city square
Posting of the provisional/final classification - Zlín, Rally HQ

Appendix 4

Competition numbers and advertising

1. The organiser reserves following places which must remain free according to this drawing:

1.1 Compulsory advertising

- | | | |
|---|----------------------|-------|
| A | - starting numbers: | Barum |
| B | - rally plates: | Barum |
| C | - rear window panel: | Barum |

1.2 Optional advertising proposed by organiser

The organiser reserves following places which must remain free:

D, E - panel 67 x 20 cm under the side door starting number: Zlín, ORLEN, ACR, Zlínský kraj, VisitCzechia

ERC - advertising stickers according to ERC regulations (valid only for drivers registered to ERC)

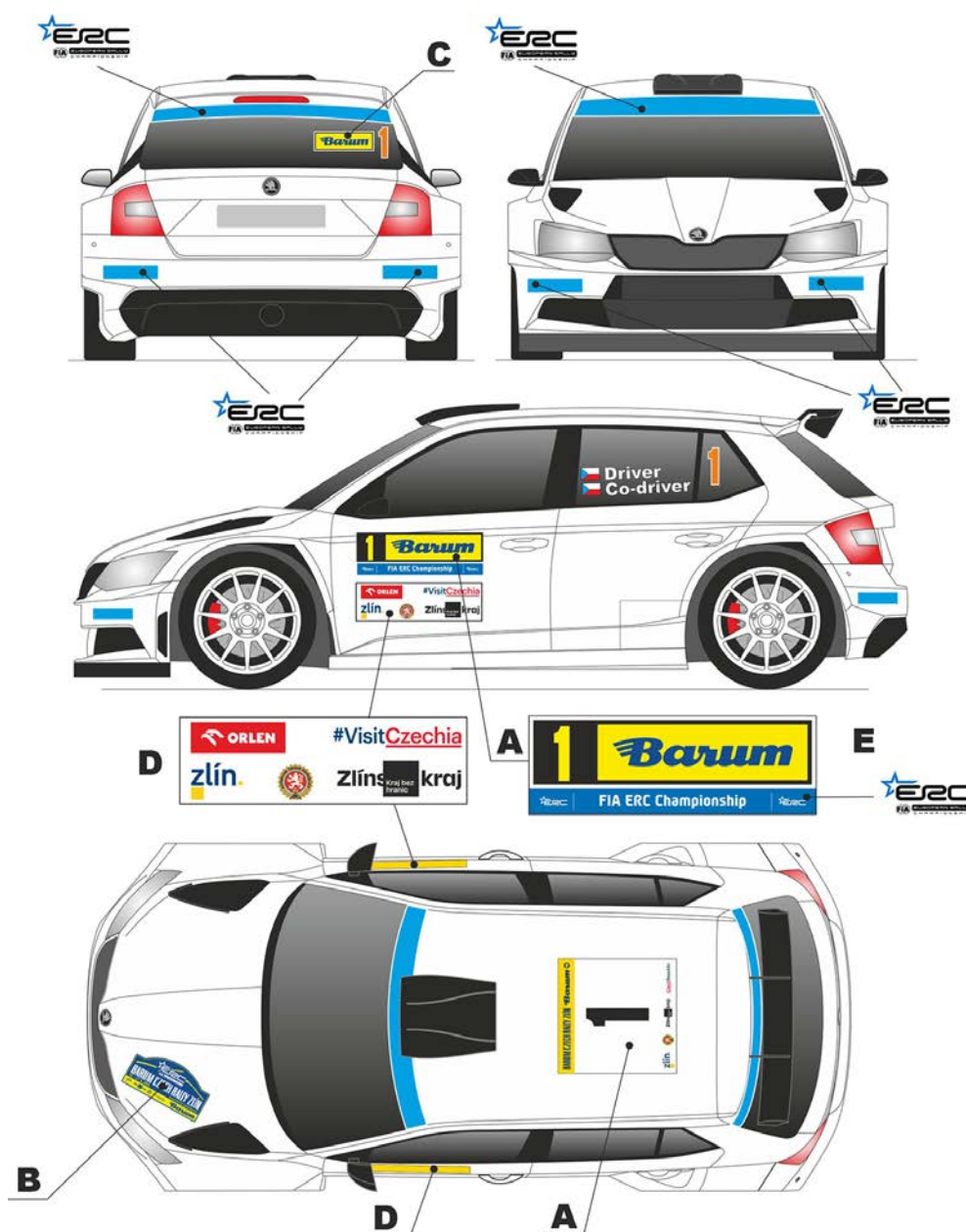

Appendix 5

Extracts from FIA ISC Appendix L relating to overalls, helmets and any other safety requirements

All competitors are reminded of Appendix L of the FIA International Sporting Code, in particular its Chapter III - Drivers' Equipment.

Helmets (Appendix L, Chapter III, Art. 1)

All crews must wear crash helmets homologated to one of the following FIA standards:

8859-2015	(Technical List N°49),
8859-2024 or 8859-2024-APB	(Technical List N°107),
8860-2010	(Technical List N°33), or
8860-2018 or 8860-2018-ABP	(Technical List N°69)

Frontal Head Restraint (FHR, Appendix L, Chapter III, Art. 3)

All crews must use FIA approved FHR systems homologated to FIA standard 8858.

Approved FHRs, anchorages and tethers are listed in Technical List N° 29.

See also helmet compatibility chart in Appendix L, Chapter III, Art. 3.3.

Flame-resistant clothing (Appendix L, Chapter III, Art. 2)

All drivers and co-drivers must wear overalls as well as gloves (optional for co-drivers), long underwear, a balaclava, socks and shoes homologated to the FIA 8856-2018 standard (Technical List N° 74).

Please pay special attention to the prescriptions of Art. 2 concerning embroidery and printing on flame-resistant clothing (manufacturer certificates etc.) **as well as concerning the correct wearing of the clothing elements! See also the 2025 FIA Regional Rally Sporting Regulations, Article 53.1**

Biometric Devices (Appendix L, Chapter III, Art. 2.1)

Drivers may wear a device to collect biometric data during racing.

If the biometric device is integrated into a protective garment homologated to FIA Standard 8856, the garment shall be homologated to FIA Standards 8856 and 8868-2018.

If the biometric device is a stand-alone device, then the device must be homologated to FIA Standard 8868-2018 only. This device must be worn in addition to the garment homologated to FIA Standard 8856.

Wearing of jewellery (Appendix L, Chapter III, Art. 5)

The wearing of any type of jewellery, such as but not limited to, neck chains, bracelets or watches is prohibited during the competition. Exceptions to this rule, providing the CMO and/or Medical Delegate do not consider that due to size or location they may delay rescue or hinder emergency care, are:

- the wearing of watch(es) by co-drivers, on the condition that the watch(es) is worn over the overall,
- the wearing of a single band-style ring providing it does not restrict the natural range of motion of the hand, and
- the wearing of body piercing(s) providing they are not worn in and/or around the oral cavity.

RELATED LINKS:

FIA International Sporting Code and appendices: <https://www.fia.com/regulation/category/123>
FIA Technical Lists: <https://www.fia.com/regulation/category/761>

Appendix 6

Monitoring GPS system SAS

All competitors must make provisions in their rally cars for the installation of the FIA Safety Emergency Console System, and the system must be installed before the car is brought to scrutineering.

Systems may be collected either by the crew or a representative, while collecting documents for Reconnaissance on Wednesday. No deposit will be collected for the rally safety tracking equipment, but all the damage caused will be invoiced afterwards.

Dismantling of the GPS SAS monitoring system

One mechanic is allowed to help the crew with unmounting the monitoring device GPS in the area between TC 13C and entrance to parc ferme.

The FIA Safety Emergency Console System devices must be removed in the final Parc Fermé and returned to the SAS tent in PF no later than 21:30 h on Sunday 17.8.2025 to the representative of STATUS AWARENESS SYSTEM (SAS).

For installation and operating instructions see complete manual on official website of the rally:

<https://www.czechrally.com/en/24890-documents>

Appendix 7

ACCOMMODATION

Luxury hotels, comfortable villas and guesthouses

Spa Luhačovice, a.s.

Tel.: +420 577 682 100

E-mail: pobyty@lazneluhacovice.cz

Web: www.SpaLuhacovice.cz

Hotel Rottal a PenzionLípa

Zlínská 172

765 02 Otrokovice-Kvítkovice

Tel.: +420 577 922 151

Fax: +420 577 922 356

E-mail: hotelrottal@hotelrottal.cz

Web: www.hotelrottal.cz

LH Hotel Jana

Koliby 2

750 02, Přerov

Tel.: +420 581 833 111

Web: www.hotel-jana.cz

Ranč Kostelany

Kostelany 200, 767 01 Kroměříž

Tel.: +420 573 367 272

Web: www.kostelany.cz

Lesní penzion Bunč

Roštín 287, 768 03

restaurace: tel +420 725 653 114

recepce: tel. +420 573 367 272

Email: info@bunc.cz

Web: www.bunc.cz

Other accommodation:

www.booking.com





SPA LUHAČOVICE

One of the most beautiful spas... just 20 km from Zlín

- luxury hotels, comfortable villas and guesthouses
 - 1300 beds
 - opportunity to relax during spa procedures and at the largest wellness center in Luhačovice

Contact us: Lázně Luhačovice, a.s., tel.: +420 577 682 330, e-mail: reservation@spaluhacovice.cz

www.SpaLuhacovice.cz



Když víš, že můžeš...

Nová SportContact™ 7.

Sportovní jízda bez kompromisů.

www.continental.cz



Stvořeny pro pohodlné cestování



EV ✓

BRAVURIS 6

Vyrobili jsme nové letní pneumatiky BRAVURIS 6, abys byl na silnici v bezpečí. Zvyšují tvůj komfort a kilometrový výkon, zároveň šetří palivo a prodlužují dojezd tvého automobilu. Barum BRAVURIS 6 milují léto, stejně jako ty.

Barum
MILES OF EXPERIENCE

Značka skupiny Continental.

www.barum-tyres.com